

Drawing



Tools for Chefs

Hendi B.V.  
 Steenoven 21  
 3911 TX Rhenen  
 The Netherlands

Batch #

000000 until  
 170565

Appliance part#

264607

Description

Salamander 450

Date 04-05-2021

Revision #

1.0

Revision First Bill of Materials (BOM)

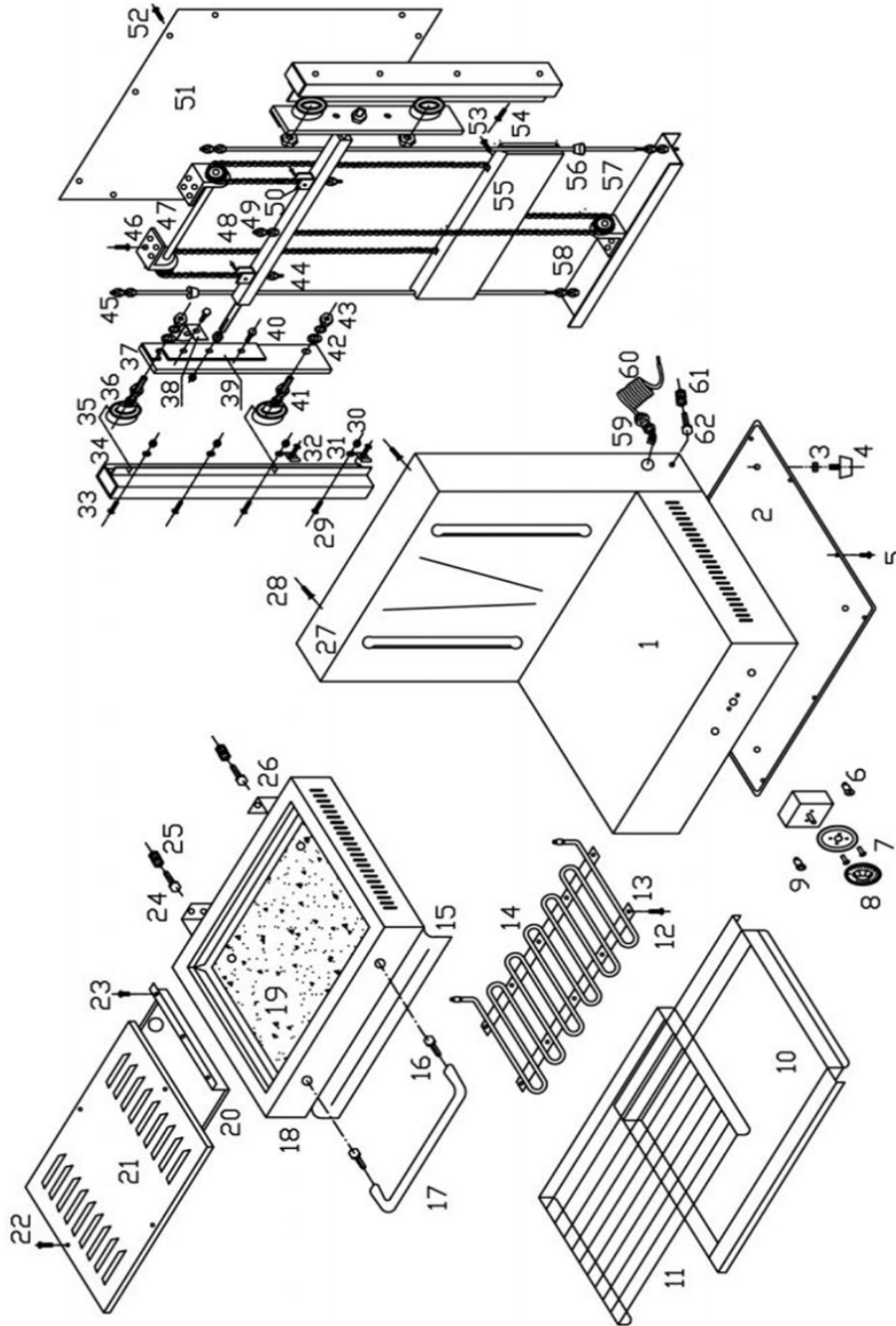

### Bill of materials (BOM)

 <b style="font-size: 24px; margin-left: 10px;">HENDI</b> <span style="color: green; font-size: 12px; margin-left: 10px;">Tools for Chefs</span> <b>Hendi B.V.</b> Steenoven 21 3911 TX Rhenen The Netherlands	<b>Batch #</b>	<b>Appliance part#</b>
	000000 until 170565	<b>264607</b>
	<b>Description</b>	
<b>Salamander 450</b>		

<b>Date</b>	04-05-2021	<b>Revision #</b>	1.0
<b>Revision</b>	First Bill of Materials (BOM)		

Item	Description	Part#	Quantity	Remark	Picture
1	Bottom Housing	n/a	1		
2	Bottom Housing Cover	n/a	1		
3	Screw for Foot	n/a	4		
4	Foot	n/a	4		
5	Screw for Housing	n/a	10		
6	Heating Indicator	912003	1		
7	Screw for Energy Regulator	n/a	2		
8	Energy Regulator	201121	1		
9	Power Indicator	205471	1		
10	Oil Drip tray	901694	1		
11	Grid	926802	1		
12	Screw for Element Bracket	n/a	4		
13	Heating Element Bracket	n/a	2		
14	Nut for Heating Element Bracket	n/a	2		
15	Heating Element	901700	1		
16	Screw for Handle	nss	2		
17	Handle	927540	1	Incl. item 16	
18	Upper Housing	n/a	1		
19	Bottom Plate Upper Housing	n/a	1		
20	Heat Shield	n/a	1		
21	Upper Housing Cover	n/a	1		
22	Screw for Upper Housing Cover	n/a	4		
23	Screw for Heat Shield	n/a	2		
24	Nut for Upper Housing	n/a	2		
25	Screw for Upper Housing	n/a	2		
26	Upper Housing Mounting Bracket	n/a	2		
27	Back Housing	n/a	1		
28	Screw for Back Housing	n/a	2		
29	Screw for Lift Bracket	n/a	8		
30	Nut for Lift Bracket	n/a	8		
31	Washer for Lift Bracket	n/a	8		
32	Mounting Clip	n/a	2		
33	Lift Bracket	n/a	2		
34	Slotted Plate	n/a	2		
35	Ball Bearing	n/a	4		
36	Ball Bearing Axis	n/a	4		
37	Side Panel Lift	n/a	2		
38	Fixation Plate	n/a	2		
39	Pressure Plate	n/a	2		
40	Bolt for Lift	n/a	2		
41	Nut for ILift	n/a	2		
42	Spring Washer	n/a	2		
43	Washer	n/a	2		
44	Guide Rod	n/a	1		
45	Washer	n/a	2		
46	Base Bracket	n/a	2		
47	Gear Wheels with Axle	n/a	1		
48	Chain for Lift	n/a	2		
49	Screw for Schain Mount	n/a	1		
50	Chain Fixation Bracket	n/a	2		
51	Back Housing Cover	n/a	1		
52	Screw for Back Housing Cover	n/a	8		
53	Screw	n/a	1		
54	Screw Chain Mount	n/a	2		

55	Counter Weight	n/a	1		
56	Rubber Stop for Counter Weight	n/a	2		
57	Guide Rod	n/a	1		
58	Base Plate for Lift	n/a	1		
59	Power Cord Retention	912201	1		
60	Power Cord	912027	1		
61	PE Copper Screw	n/a	1		
62	PE Copper Nut	n/a	1		
*	Knob	n/a	1	Knob updated to new design (904466)	

n/a -> not available

nss -> not sold separately

**Circuit diagram**

 <b>HENDI</b> Tools for Chefs <b>Hendi B.V.</b> Steenoven 21 3911 TX Rhenen The Netherlands	<b>Batch #</b>	<b>Appliance part#</b>
	000000 until 170565	<b>264607</b>
	<b>Description</b>	
	Salamander 450	

<b>Date</b>	04-05-2021	<b>Revision #</b>	1.0
<b>Revision</b>	First Bill of Materials (BOM)		

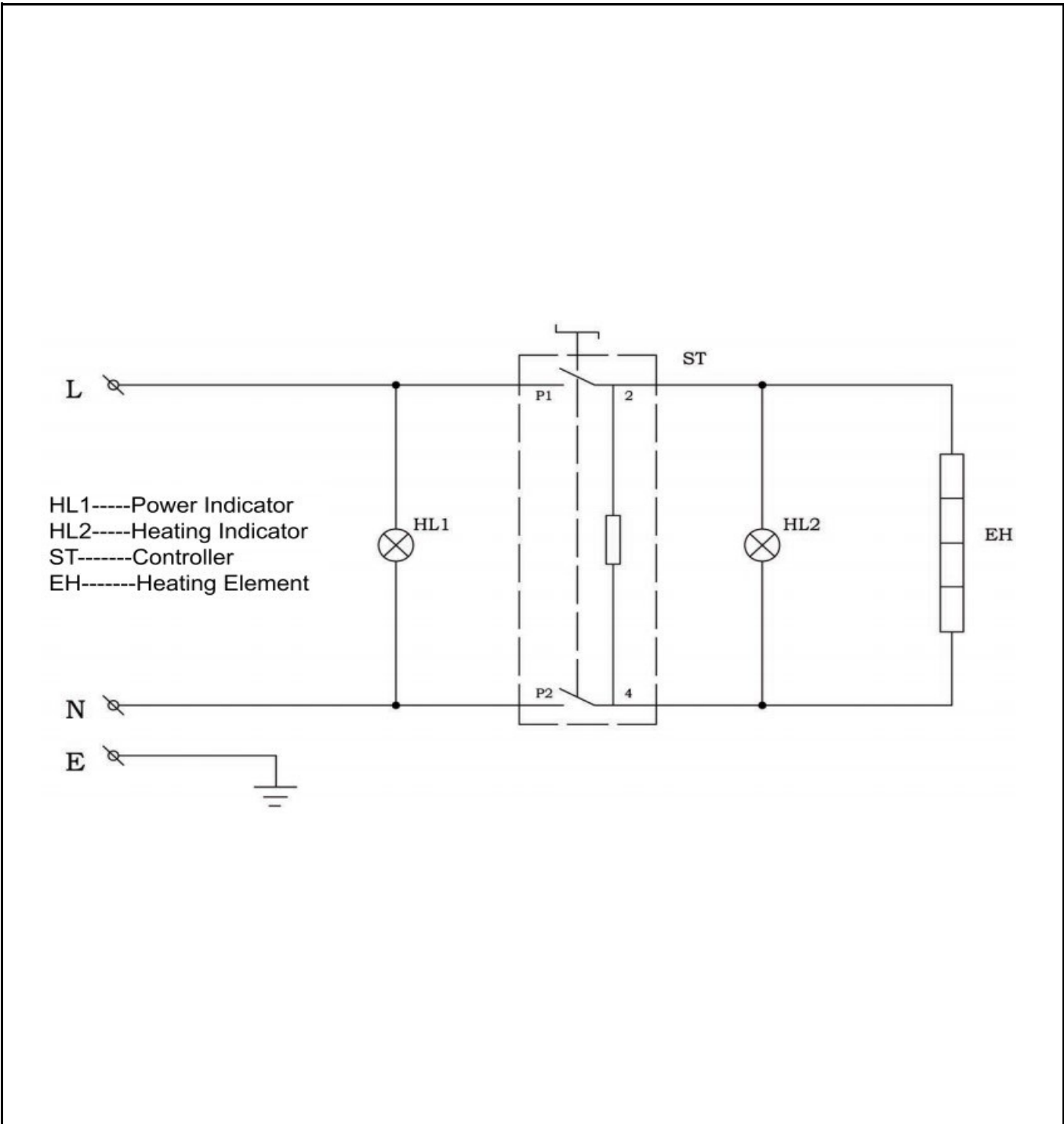

# Wiring diagram

 <b>HENDI</b> Tools for Chefs Hendi B.V. Steenoven 21 3911 TX Rhenen The Netherlands	<b>Batch #</b>	<b>Appliance part#</b>
	000000 until 170565	<b>264607</b>
	<b>Description</b>	
	Salamander 450	

<b>Date</b>	04-05-2021	<b>Revision #</b>	1.0
<b>Revision</b>	First Bill of Materials (BOM)		

