

Uponor

Uponor Q&E Ø 9,9-50 mm

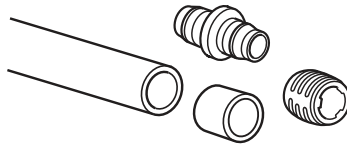

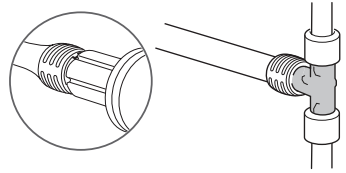

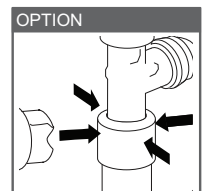
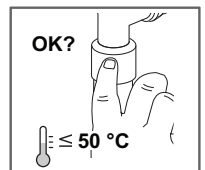
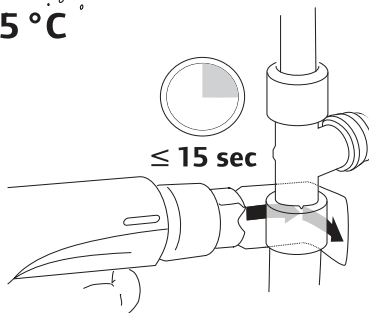
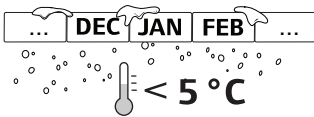
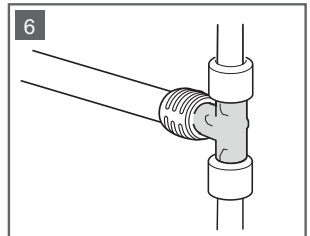
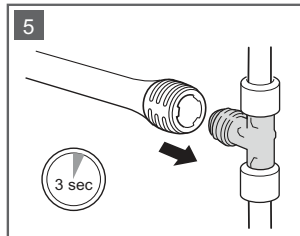
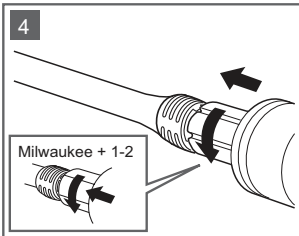
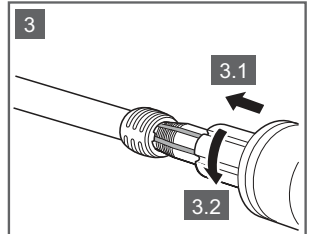
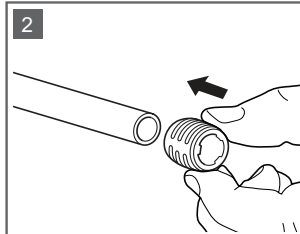
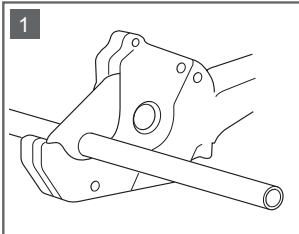



Uponor Aqua Pipe
Uponor Combi Pipe
Uponor Comfort Pipe
Uponor Comfort Pipe PLUS
Uponor Comfort Pipe PN10
Uponor Radi Pipe











MP



|  mm |  |  |  M12/M18 |  M12+MP/RS |  M18+MP/RS | | |
|---|---|---|--|--|--|--------------|---------------|
| 6 bar | | | | 21 °C | -10 °C | 21 °C | -10 °C |
| 9,9x1,1 | 9,9 | Q&E 9,9 | RS 9,9x1,1 | 5 | 4 | 6 | 4 |
| 12x1,1 | 12 | Q&E 12x1,1 | 12x1,7/1,8/2,0 | 7 | 5 | 9 | 8 |
| 14x2,0 | 14/15x2,5 | Q&E 14 | 14/15x2,5 | 6 | 6 | 6 | 7 |
| 16x1,5/1,8/2,0 | 16 | Q&E 16 | RS16x1,8/2,0/2,2 | 4+1 | 4 | 4+1 | 4 |
| 17x2,0 | 17/18x2,5 | Q&E 17 | 17/18x2,5 | 8 | 8 | 8 | 8 |
| 20x1,9/20x2,0 | 20 | Q&E 20 | 20x1,9/2,0/2,3 | 5+2 | 6 | 6 | 6 |
| 25x2,3 | 25 | Q&E 25 | 25x2,3 | 8+2 | 10 | 9 | 9 |
| 32x2,9 | 32 | Q&E 32 | 32x2,9 | 15 | 16 | 14 | 14 |
| 40x3,7 | 40 | Q&E 40 | H 40x3,7* | - | - | 7+1 | 14 |
| 10 bar | | | | 21 °C | -10 °C | 21 °C | -10 °C |
| 12x1,7 | 12 | Q&E 12x1,1 | 12x1,7/1,8/2,0 | 5+1 | 5+1 | 4+1 | 5 |
| 12x2,0 | 12 | Q&E 12x1,1 | 12x1,7/1,8/2,0 | 4+2 | 5+1 | 4+1 | 4+1 |
| 16x2,2 | 16 | Q&E 16 | RS16x1,8/2,0/2,2 | 5+4 | 4+1 | 5+4 | 5+1 |
| 20x2,8 | 20 | Q&E 20 | 20x2,8 | 10 | 11 | 10-11 | 11 |
| 25x3,5 | 25 | Q&E 25 | 25x3,5 | 17 | 18 | 19 | 19 |
| H 32x4,4 | 32 | Q&E 32 | H32x4,4* | - | - | 7+3 | 8+2 |









Fuel

|  mm |  |  |  M12/M18 |  M12 Fuel + MP |  M18 Fuel + MP | | |
|---|---|---|--|--|--|--------------|---------------|
| 6 bar | | | | 21 °C | -10 °C | 21 °C | -10 °C |
| 9,9x1,1 | 9,9 | Q&E 9,9 | 9,9x1,1 | 5 | 4 | 6 | 4 |
| 12x1,1 | 12 | Q&E 12x1,1 | 12x1,7/1,8/2,0 | 7 | 5 | 9 | 8 |
| 14x2,0 | 14/15x2,5 | Q&E 14 | 14/15x2,5 | 6 | 6 | 6 | 7 |
| 16x1,5/1,8/2,0 | 16 | Q&E 16 | 16x1,8/2,0/2,2 | 4+1 | 4 | 4+1 | 4 |
| 17x2,0 | 17/18x2,5 | Q&E 17 | 17/18x2,5 | 8 | 8 | 8 | 8 |
| 20x1,9/20x2,0 | 20 | Q&E 20 | 20x1,9/2,0/2,3 | 5+2 | 6 | 5+2 | 6 |
| 25x2,3 | 25 | Q&E 25 | 25x2,3 | 8+2 | 10 | 8+2 | 8 |
| 32x2,9 | 32 | Q&E 32 | 32x2,9 | 15 | 16 | 15 | 16 |

*) H = Milwaukee tool M18









Fuel

|  mm |  |  |  M12/M18 |  M12 Fuel + MP | |  M18 Fuel + MP | |
|---|---|---|--|--|--------|--|--------|
| 10 bar | | | | 21 °C | -10 °C | 21 °C | -10 °C |
| 12x1,7 | 12 | Q&E 12x1,1 | 12x1,7/1,8/2,0 | 5+1 | 5+1 | 4+1 | 5 |
| 12x2,0 | 12 | Q&E 12x1,1 | 12x1,7/1,8/2,0 | 4+2 | 5+1 | 4+1 | 4+1 |
| 16x2,2 | 16 | Q&E 16 | 16x1,8/2,0/2,2 | 5+4 | 4+1 | 5 | 5+1 |
| 20x2,8 | 20 | Q&E 20 | 20x2,8 | 10 | 11 | 8+2 | 8 |
| 25x3,5 | 25 | Q&E 25 | 25x3,5 | 17 | 18 | 17 | 18 |
| 32x4,4 | 32 | Q&E 32 | H 32x4,4* | - | - | 7+3 | 8+2 |





Fuel

|  mm |  |  |  RS |  M12 Fuel+RS | |  M18 Fuel+RS | |
|---|---|---|---|--|--------|--|--------|
| 6 bar | | | | 21 °C | -10 °C | 21 °C | -10 °C |
| 9,9x1,1 | 9,9 | Q&E 9,9 | RS 9,9x1,1 | 6 | 4 | 10 | 6 |
| 16x1,5/1,8/2,0 | 16 | Q&E 16 | RS 16x1,8/2,0/2,2 | 4+1 | 4 | 4+2 | 5+1 |
| 20x1,9/20x2,0 | 20 | Q&E 20 | RS 20x1,9/2,0 | 5+5 | 5+1 | 5+4 | 5+1 |
| 25x2,3 | 25 | Q&E 25 | RS 25x2,3 | 7+7 | 7+1 | 6+2 | 6 |
| 32x2,9 | 32 | Q&E 32 | RS 32x2,9 | 10+1 | 11 | 11+1 | 11 |
| 40x3,7 | 40 | Q&E 40 | H 40x3,7* | - | - | 8+1 | 9 |
| 50x4,6 | 50 | Q&E 50 | 50x4,6 | - | - | 6 | 6 |
| 10 bar | | | | 21 °C | -10 °C | 21 °C | -10 °C |
| 16x2,2 | 16 | Q&E 16 | RS16x1,8/2,0/2,2 | 5+4 | 4+1 | 5+4 | 5+1 |
| 20x2,8 | 20 | Q&E 20 | RS 20x2,8 | 9+6 | 8 | 8+2 | 7 |
| 25x3,5 | 25 | Q&E 25 | RS 25x3,5 | 14 | 13 | 14 | 14 |
| 32x4,4 | 32 | Q&E 32 | H 32x4,4* | - | - | 7+3 | 7+1 |
| 40x5,5 | 40 | Q&E 40 | H 40x5,5* | - | - | 6+4 | 5+2 |
| 50x6,9 | 50 | Q&E 50 | 50x6,9 | - | - | 9+2 | 11 |

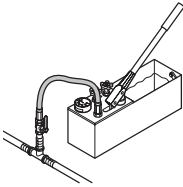
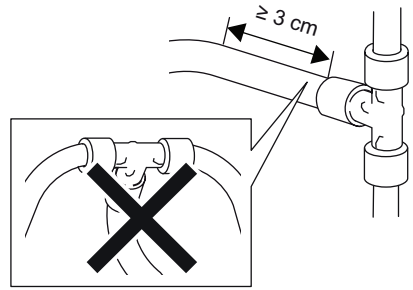
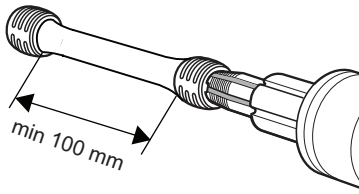
*) H = Milwaukee tool M18



|  °C |  h |
|--|---|
| >+10 | 0,25 |
| +10 - +5 | 0,5 |
| +5 - ±0 | 1,5 |
| ±0 - -5 | 3,0 |
| -5 - -10 | 4,0 |
| -10 - -15 | 8,0 |

(optional)



 [x operating pressure]

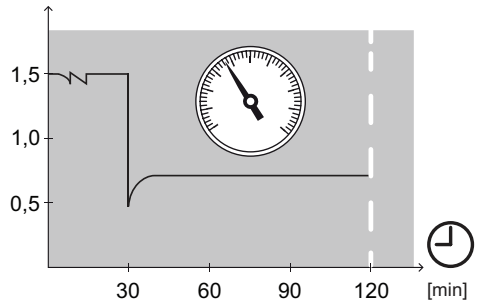

Milwaukee M18



www.uponor.com/services/download-centre

Uponor GmbH

Industriestraße 56

D-97437 Hassfurt, Germany

1121763_v4_10_2021_INT

Production: Uponor/SDE

4931 4812 07 (MW EMEA No.)

961014415-01(A) (MW TTI No.)

Uponor reserves the right to change specifications without prior notice, in keeping with our policy of continuous improvement and development.



www.uponor.com