

E.C.A. MYRA SHOWER MIXER

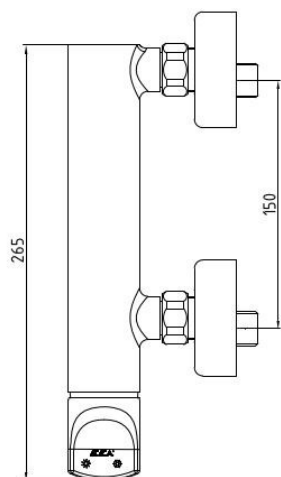
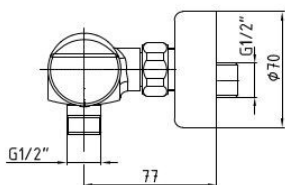
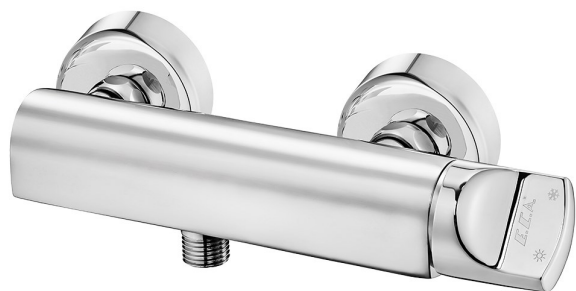

Product Description

Product Number	102154023HEX
Product Name	Shower Mixer
EAN Barcode	8693261079681

Technical Specification

Cartridge Type	Ø35 mm Ceramic Cartridge
Min. Water Pressure	0,5 bar
Max. Water Pressure	10 bars
Recommended Water Pressure	3 bars
Nominal Flow Rate @3bars	13,7 l/m
Inlet Water Temperature	5°C - 65°C
Supply Connection	G 1/2" S-Unions
Finishing	Chrome with Hygiene Plating
Body Material	Brass

Color Options

104354023EX	Red - Chrome
104454023EX	Beige - Chrome
104554023EX	Black - Chrome
104154023EX	White - Chrome
102154023C4EX	Matt White

Product Variants

102154023Hxx	xx Localization Product Number
--------------	--------------------------------

Flow Rate Chart

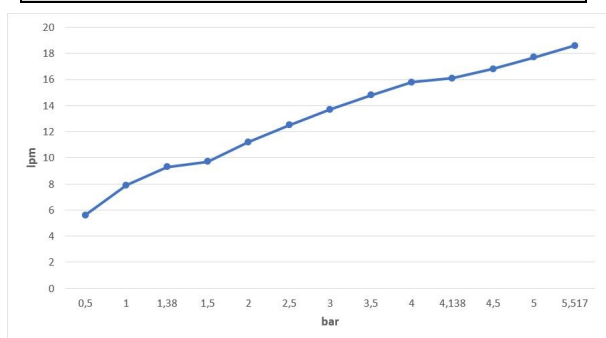

April 2022

We reserve the right to alter product specification and colors and to make technical modifications without prior notice.

www.ECA.com.tr