

Fino al / Until 09.2015

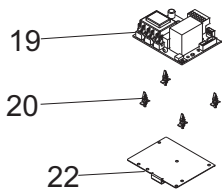

**Per/For Ref. 22
order Ref. 27**

| | | |
|-------|---|-----------------|
| 1 | MANIGLIA COPERCHIO SOFT S-R 1/1 2/3 | GM2486085 |
| 2 | COPERCHIO SOFT-SR 1/1 | GM9869105 |
| 3 | SCREW POELIERS M5 X 8 | IX2POEL005008 |
| 4 | PROTEGGI PRODOTTO SOFT-SR 1/1 | GM2483550 |
| 5 | BACINELLA SOFT-SR 1/1 LAVORATA | GM9889180 |
| 6 | ANGOLARE VASCA | GM2483290 |
| 7 | FLAT WASHER DIN 125 D 6 | IX2125006 |
| 8 | HEX.NUT DIN 934 M 6 | IX2934006 |
| 9 | MANIGLIA VASCA SOFT COOKER | GM2486095 |
| 10 | CABLE SOFTCOOKER S | GM5506025 |
| 10 CN | CAVO STERILIZZATORE SPINA CINESE | GM5506815 |
| 11 | PRESSACAVO E DADO PG 11 | GM5893040 |
| 12 | HEX.NUT DIN 934 M 4 | IX2934004 |
| 13 | INVOLUCRO SOFTCOOKER 1/1 SR | GM2486475 |
| 14 | CONTROL BOARD + CORD SOFTCOOKER | GM5946350 |
| 15 | SPACER DCK R 52100 _ SOFTCOOKER Y09 | GM4696275 |
| 16 | FACEPLATE - SOFTCOOKER Y09 | GM8156700 |
| 17 | RACCORDO RUBINETTO 1/2" SOFT-SR | GM2210170 |
| 18 | RUBINETTO 1/2" M/F SOFT-SR | GM2210160 |
| 19 | PCB SOFTCOOKER S | GM5946330 |
| 20 | SPACER CF06H4080 MM 08_ SOFTCOOKER | GM4696300 |
| 21 | UPPER ELEMENT, PD POWER | IGS103093 |
| 23 | WIRING SOFTCOOKER SR | GM5556480 |
| 25 | PIASTRA SUPP.RESISTENZA SOFTC SR | GM2486890 |
| 26 | MOLLA SUPPORTO SOFT COOKER STATICO | GM3085150 |
| 27 | OMEGA SUPP. RESISTENZA SOFTC. SR 1/1 SX | GM2483280 |
| 28 | PIEDINO GOMMA | GM4356000 |
| 29 | VITE AUTOF.TC+ DIN 7981 D 3,5X9,5 | IX279813.5009.5 |
| 30 | FONDO SOFT-SR 1/1 | GM2483295 |
| 31 | PROBE - SOFT COOKER S | GM5826175 |
| 32 | OMEGA SUPP.RESISTENZA SOFTC.1/1 SR | GM2483260 |
| 33 | ISOLANTE CORNICE VASCA 1/1 | GM6206490 |